



# ASSEMBLY INSTRUCTIONS

- CAUTION: Do not force the joint connecting the Light Head to the Support Arm beyond its range of motion. The joint will fail and create a hazardous condition.
- When first received, in order to avoid damage please use the following procedure to remove the Light Head from the box and assemble.

## ASSEMBLY

- ① Careful not to damage the cord, rotate the Support Arm horizontally in the direction of the arrow.
- ② Be careful of the cord while removing from the box.

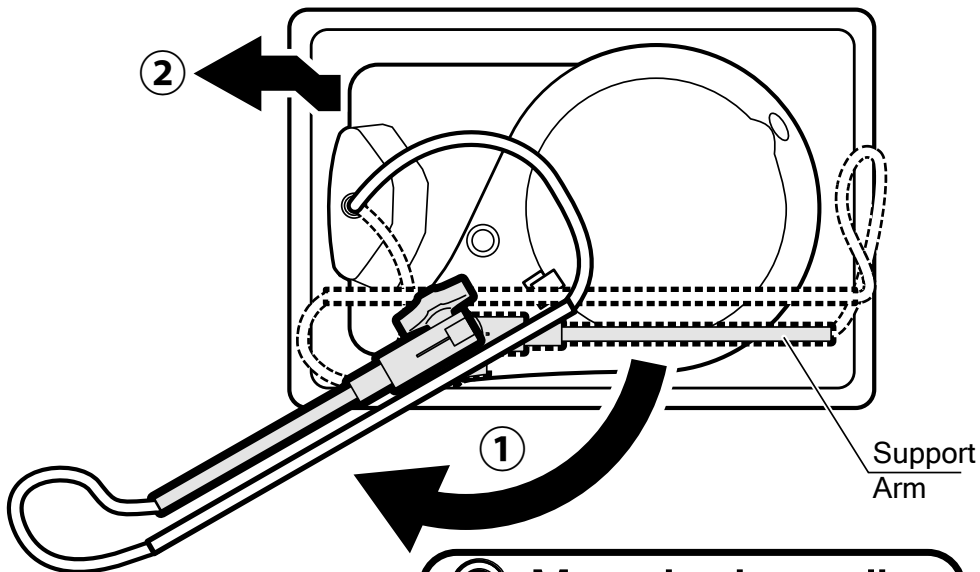

○ Move horizontally

✗ Do not lift arm up

※ It may cause damage

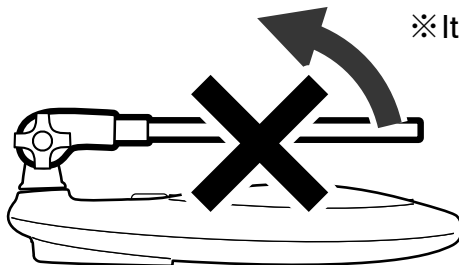

※Note, drawing omits ties, cord, etc. for clarity. Actual packaging may differ.

## ASSEMBLY (cont.)

- ③ Insert the Main Post all the way into the hole in the Support.
- ④ Secure with the Socket Head screw using the 3mm Hex Wrench.
- ⑤ Attach the Support Arm; make sure the Head Clamp is oriented pointed down as shown in the diagram.

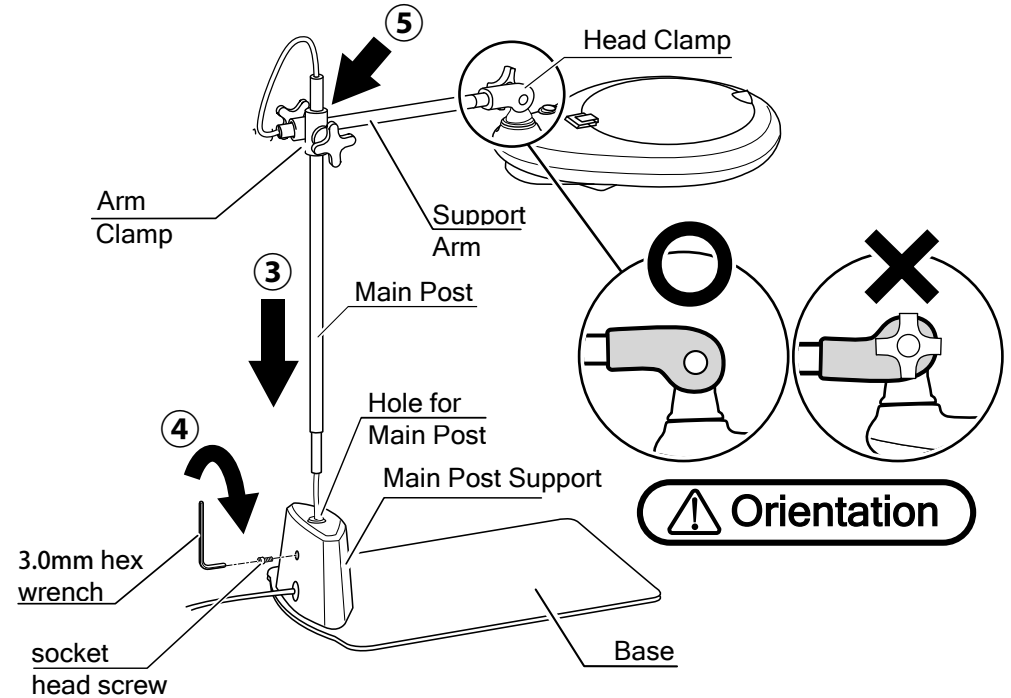

## Head Joint Range of Motion

Horizontal

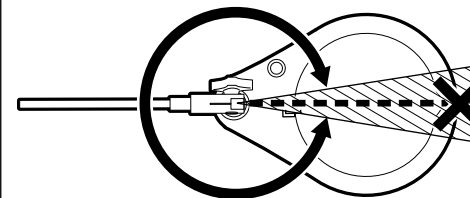

⊘ Never rotate the head toward the Support Arm beyond the center of Lens.

Vertical

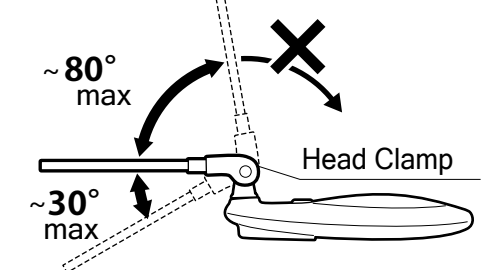

Instruction Manual: Other side

## LS4-150S

### ■ Makes work easy - Hands free; Well lit; Wide view.

Thank you for purchasing the LS4-150S LED Stand Magnifier.  
Please read this manual thoroughly before use to insure proper operation and long service.

### ■ BEFORE USE

◆ Read and Follow for Safe Use of Product

#### ⚠ WARNING

- To prevent electrical shock, always make sure power is OFF before assembly or attaching/detaching lens or cleaning the equipment.
- Never look at sun or bright light through the lens. There is risk of damage to eyesight.
- Do not expose lens to sunlight or intense light, there is risk of starting fire.
- Never leave lens in location where it can be exposed to direct or reflected sunlight. Close the lens cover when not in use in order to prevent starting fire.
- When installed on a sloped surface the unit may slip causing malfunction, damage, or injury. Do not install on surface with incline of more than 5° from horizontal.
- Do not use the power cord for lifting or moving, and never pull on the cord. There is risk of the unit falling, or damage to the cord which may result in injury or fire.

#### ⚠ CAUTION

- Handle with Care. Do not drop, scratch, or use strong force with product. (Use special care when cleaning.) Damage to product may cause injury.
- Do not wash the lens with water. Water in long contact with lens may cause mold or cloudiness.
- The LED light is capable of frequent on/off cycles, but to avoid wear and damage to the switch, do not cycle the switch unnecessarily.
- This product contains metal bearing surfaces and may produce trace amount of dust and powder due to repeated friction on metal surfaces. Therefore, it is not suitable for clean-room applications. If there is concern over exposing workpiece to contamination, do not use for that application or take care not to reposition light while above workpiece.
- Base Plate surface may scratch table if slid upon it. To prevent damage, place protective sheet or board under unit to protect the table.
- Place workpiece on base plate, as moving the lens too far to the side may cause the light to topple. Do not forcibly move any parts beyond their limits and use care to prevent instability.

### CARE & STORAGE NOTES

- Please keep lens clean of dust and fingerprints.
- Clean lens gently with dedicated lens cloth. Do not wash with abrasive cleaners, or rinse with water.
- Keep lens protection cover in down position, and unplug power cord when not in use for extended period.

### ■ SPECIFICATIONS

Rated voltage	AC100V	Magnifying Lens	4x Magnification lens SL-4 Type: White Glass lens Magnification: ~4x Viewable diameter: ~φ140mm
Rated freq.	50/60Hz		
Rated power	15W		
Light source	84x white LED		
Color temp.	~5,000K (daylight)	Material	Head : Polycarbonate Base : Steel
Efficiency	100lm/W		
Weight	~ 5.3 kg	Cord Length	~1.8m
Height	~ 430mm	Accessories	Lens cloth, 3.0mm hex wrench

### ■ PART NAMES, DIMENSIONS

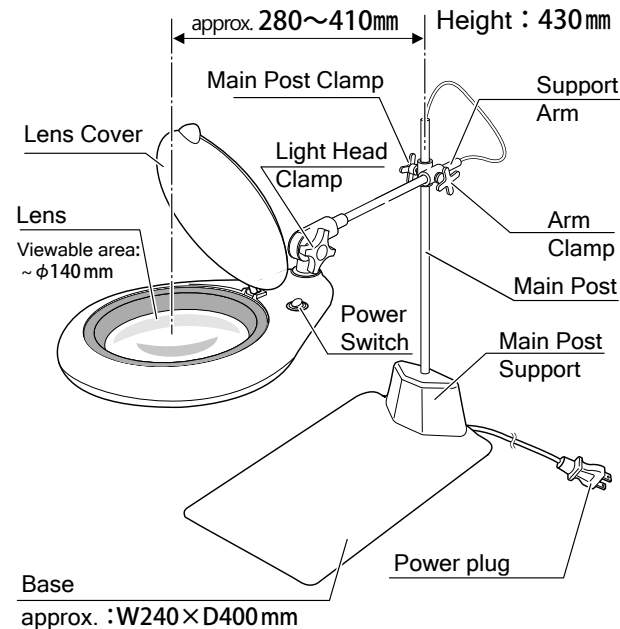

### ■ HOW TO USE

- For best results, and to prevent eye fatigue, adjust the Lens so that it is parallel to the surface you wish to inspect, and securely tighten the Clamps.
  - ※ The best lens position will depend on distance between eyes and the workpiece.
- Plug in the cord and turn on the Power Switch.
  - ※ Position unit so that external lights, such as the ceiling fixtures, are not reflected in the lens.
- After use, close the Lens Cover, turn off the Power Switch, and unplug the Power Cord.

#### ■ Optional Replacement Lens:

- 2x Magnification Lens
  - Model No. : SL-2
  - Magnification : ~2x
  - Viewable area : ~φ170mm

**Niigata Seiki Co., Ltd.**

6-15-22, Tsukanome, Sanjo, Niigata, Japan 955-0055  
 TEL: +81-256-31-5670 FAX: +81-256-39-7730  
 MAIL: intl.sales@niigataseiki.co.jp  
 URL <http://www.niigataseiki.co.jp>

E1046-Q2

1810500