

# Autoclave

## Falcon Series

The autoclaves are designed with traditional mechanical engineering for customers who are accustomed to and prefer straightforward, nuts-n-bolts autoclaves with time-tested quality and durability that is both economical and practical.

Control panels are designed with simple controls which make these autoclaves also ideal for non-medical applications, such as tattoo parlors and beauty salons.



# Autoclave

## Falcon Series

### Features

- Graduated sterilization timer
- Mechanical pressure control system
- Pressure overload protection
- Overheat protection
- Pressure auto door lock
- Emergency button
- Chamber volume: 24 L / 40L / 50L



# Autoclave

## Falcon Series

SA-252F External View

A Pressure Gauge



B The yellow mark is full water level



C Filling / Draining Water Valve



D Door Handle



# Autoclave

## Falcon Series

SA-300H External View

A Pressure Gauge



B The yellow mark is full water level



C Filling / Draining Water Valve



D Door Handle



# Autoclave

## Falcon Series

SA-300VF External View

**A** Pressure Auto Door Lock



**B** Door Handle



**C** Security Hook



**D** Pressure / Temperature Gauge



Reliable Sterilization Partner

# Falcon Series

SA-252F Control Panel

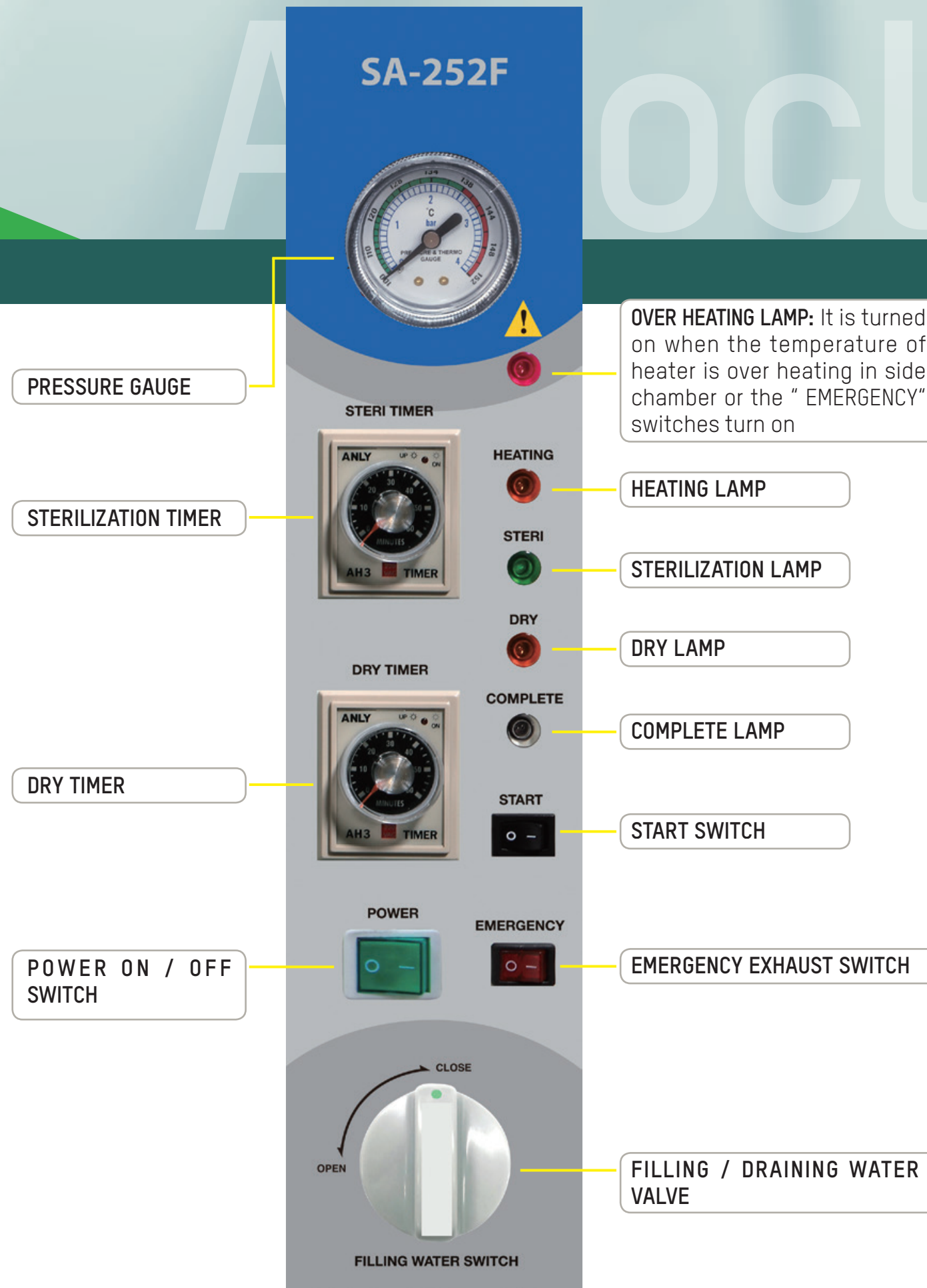

Reliable Sterilization Partner

# Falcon Series

SA-300H Control Panel

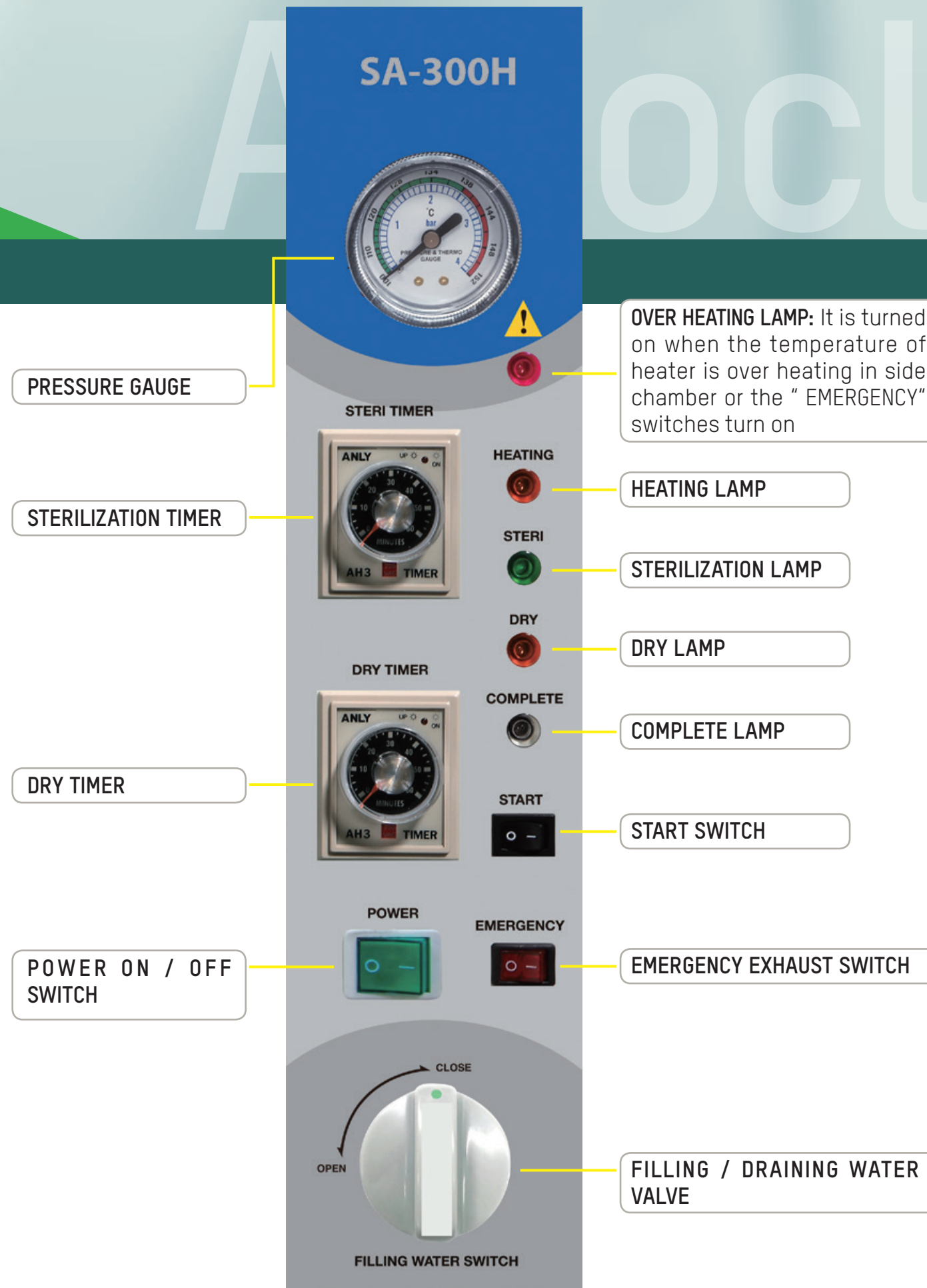

Reliable Sterilization Partner

# Autoclave

## Falcon Series

SA-300VF Control Panel

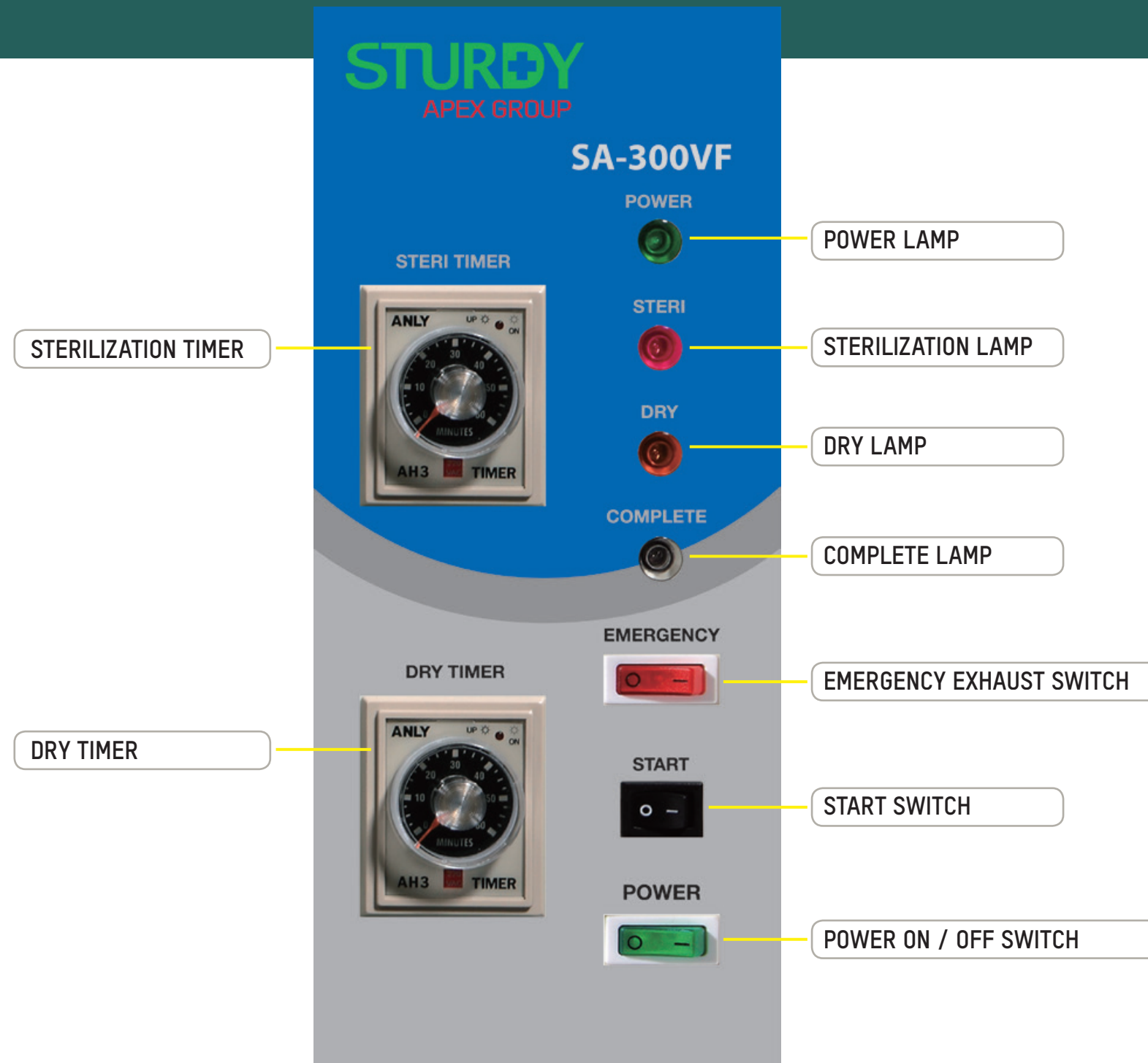

Reliable Sterilization Partner



# Autoclave

## Falcon Series

### Certifications

Sturdy is manufactured in compliance with the following directives and standards:

- 93/42/EEC
- Class IIB (European Directive for Medical Devices)
- 2014/68/EU (Pressure Equipment Directive)
- EN 285 (Large Steam Sterilizers),
- EN 13060 (Small Steam Sterilizers)
- EN 61010-1/-2-040 (Safety Requirements for Electrical Equipment for Measurement Control And Laboratory Use – Part 1 and Part 2)
- EN 61326-1 (Electrical Equipment for Measurement Control And Laboratory Use – EMC Requirements – Part 1: General Requirements)
- ISO 13485 (Quality Management/Certification)

# Autoclave

## Falcon Series

### Specifications

SPEC/Model NO.	SA-252F	SA-300H	SA-300VF
Chamber Capacity (L)	24	40	50
Chamber Size Diam x Depth (mm)	260 x 450	300 x 570	300 x 710
Overall Dimensions W x H x D (mm)	540 x 450 x 630	600 x 470 x 740	600 x 1090 x 450
Voltage (V)	230		
Current(A) / Power(W)	9A / 2063W	12A / 2735W	13A / 3100W
Heater (W)	1800	2300	
Dry Heater (W)	263	435	800
Net Weight (Kg)	45	66	72
Water Fill*	Tank-Man		Manual
Type	Tabletop		Vertical
Water Tank Capacity (cc)	4200	8400	N/A
Water Consumption per cycle (cc)	400-550		800-1000

\* "Tank-Man" - Contains water tank but still requires knob to be manually turned on/off to fill chamber. "Manual" - Must add water manually for each session.

# Autoclave

## Falcon Series

### Specifications

SPEC/Model NO.	SA-252F	SA-300H	SA-300VF
Temperature Options ( °C)		118-134	
Sterilization Timer		0-60 min.	
Dry Timer		0-60 min.	
Progress Indicator (bar or lights)		S	
Power Indicator		S	
Pressure Auto Lock		S	
Error Indicator		S	
Liquid		0	
Temperature Indicator		Gauge	
Pressure Indicator		Gauge	
Prion		N/A	
Bowie Dick Test		N/A	
Pump Test		N/A	
Redry		N/A	
Data Recorder		N/A	
Door Closed Indicator		N/A	
Low Water Indicator		N/A	
Reset		N/A	
Program Selector		N/A	
Pre-Vacuum		N/A	
Post Dry Vacuum		N/A	

Note: "S" - Standard configuration. "0" - Optional configuration.